



Evaporative Air Cooler User Manual



ZC-76Y3-2

Please keep the user manual safely.
Please read the user manual carefully before you use the machine.

11, The common malfunctions and solutions

Malfunctions	Possible reason	Solutions
A. Unable to on/off	a. Not connect the power supply b. The control board have fault	a. Check the plug b. Change the control board
B. Burn out the fuse continually	a. The submerged pump is broken	a. Change a new submerged pump
C. Water leakage	a. Lay up the machine oblique b. Water tank leak out water c. Have not tight wrested the drain off screw nut.	a. Move the machine to a horizontal place b. Repair the water tank
D. Have big noise	a. The fan blade is dirty, transmutative or broken b. Motor is worn-out c. Have sundries on the air intake or air outlet	a. Clean or change the fan blade b. Change the motor c. Clean the barriers
E. No air supply or the wind is too small	a. Wetted curtain or filter have been blocked up b. Air blower do not work or work slowly	a. Clean or change the wetted curtain and filter b. Check the motor if it is broken
F. Cooling failure	a. Do not have enough water in the water b. The water level control system have fault c. Submerged pump broken d. Control board have fault.	a. Add water into the water tank b. Check the water level sensor c. Change the submerged pump d. Change the control board
G. There is white precipitation in the water tank or on the filter	a. The water from the water supply is too hard	a. Add the cleaning frequency

Note: if there is further update, will not be arranged again.

1, Brief introduction

Evaporative Air Cooler have the below advantages:

- a. Energy-saving: compare to the air conditioners, can save more than 80% energy.
 - b. Environmental protection: when the machine works, it never releases any harmful substance. Don't have Freon.
 - c. High-efficient: can use the least energy to create biggest cooling purified effect.
- Evaporative Air Cooler suit for the whole world. They use the newest fan blade. They have the high revolution, high-airflow.

The working principle is to let the water change to the steam in a short time. It will absorb the heat in the air, consequently the temperature is down. When it works, water-pump pumps water from water tank. The water then spreads the water onto the heat exchanger which produced by special materials. The high-airflow fan blade rotates with high-speed. The fresh air from the outdoor passes the heat exchanger with high speed. At the same when the water change to steam, create many hydroxide ion. The fresh air with hydroxide ion enters the room, and the nepheloid air will exhaust through the open doors and windows to the outdoor. When the machine works circle, the temperature of the indoor reduces, and also the indoor air is cleaned.

This appliance is not intended for use by persons (including children) with reduced physical , sensory or mental capabilities, or lack of experience and knowledge, unless they have been given supervision or instruction concerning use of the appliance by a person responsible for their safety.

Children should be supervised to ensure that they do not play with the appliance.

If the supply cord is damaged, it must be replaced by the manufacturer, its service agent or similarly qualified persons in order to avoid a hazard.

2, Application scenarios

Because the evaporative Air Cooler have the advantages: cooling, humidify, fresh, energy- saving. It can use many place:

- a. Processing industry: electron, electroplating, shoemaking, dye, plastic, make clothes, print, package, food etc.
- b. Manufacturing industry: textile, machinery, ceramics, chemical, metallurgy, glass, hardware, leather etc.
- c. Hospital, clinic, school, waiting room, internet bar, department store, supermarket, washing room etc.
- d. Kitchen, market, entertainment center, underground parking , station.
- e. Greenhouse, flowers, breeding farm.
- f. Indoor occasions/places with a high temperature coming from heat sources.

Evaporative Air Cooler

4,Control Board

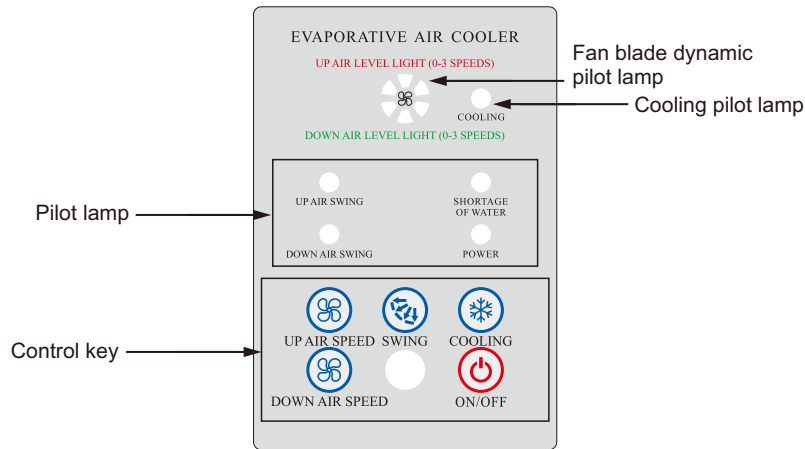

5,Operation guidance

- Open the package, get out the machine, put it on a horizontal ground.
- Open the filler, fill fresh water or connect the tap water pipe with the filler. Please note the water level can not higher than the "H" scale water level of the water tank.
- Check the power supply is the same as the data on the nameplate.
- Plug the connector plug, press the "on/off" Choose a suit wind speed, the evaporative ventilator works.
- "on/off" key
When you connect the power supply, the power pilot lamp is on. Press "on/off" ±The machine will works by "blast" ±Fanblade dynamic pilot lamp and the running pilot lamp will on.
- "cool" key
On the "Call Waiting" or "blast" model, press the "cool" key, the machine will work by the cooling model. The cool pilot lamp is on. Press the "cool" key again. The machine will work by the "blast" model, the cool pilot lamp is off.
Note: when the water tank don't have enough water, the system is working from the cool model to blast model, cooling pilot lamp is on, no water pilot lamp is on. The buzzer will sound the alarm bell.
- "up airspeed" key
In "air supply" or "cooling" mode, press "up airspeed" to switch the three air speeds of the upper air outlet. The air speed indicator shows the current speed status. The more indicator lights indicate the higher the speed.
- "down airspeed" key
In the "air supply" or "cooling" mode, press "down air speed" to switch the three air speeds of the down air outlet. The air speed indicator shows the current speed status. The more indicator lights indicate the higher the speed.
Note: The up air speed and down air speed functions are independent and do not affect each other.
- "Pendulum wind" key
Press pendulum wind key, the machine will work on pendulum wind model. Press again, the pendulum wind model will stop.

Note: this machine is suitable for indoor use.

Evaporative Air Cooler

10,Maintenance

Unplug the appliance during filling and cleaning

Clean the wetted curtain and filter

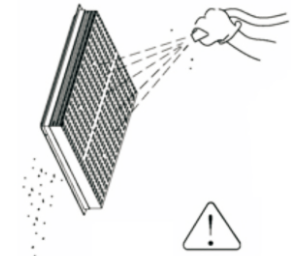
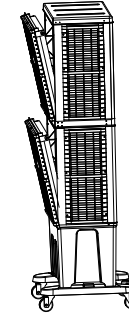

Note: the water pressure can not be too high when cleaning. Forbid to use acidic or alkaline detergent to wash the wetted curtain.

Pull off the plug, removal the 6 screws on the shutters. Catch the above of the shutters by hand. Pull the wetted curtain above lightly.

Pull above the filter

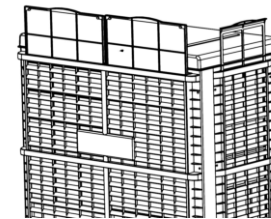

Wash the filter every week.

Wash the water tank

1. Pull of the plug, removal the screws on the shutters, take down the shutters.
2. Wriggle the drainage valve at the bottom by hand.
3. Use softy cloth or brush to wash the chassis.
4. Use wet cloth to clean the fouling on the water level sensor.
5. Use brush to clean the fouling on the pump and filter.

Wash cover

Use gentle bowl deodorizer and softy cleaning cloth to wash.(do not use the detergent which can produce foam, volatile solvent, hard brush to clean. The wrong cleaning can break the machine)

Evaporative Air Cooler

Clean the water tank, clean the wetted pad, move the machine, long time for no use the machine. Please pull off the plug from the socket



Maybe injured you or get an electric shock

Repair the machine, should to call the person whom is designated by the supplier



Easy to cause negative effects

Use the water with water pressure 0.15MPa to 0.6MPa to supply water. The temperature of the water can not higher than 45°C



Maybe cause the wetted pad dissolution, plastic deformation, broken

Please do not to put foreign body into the air intake and air outlet. Please do not let children close to the running machine. And do not let anybody put anything into the protecting net



Will be injured by the fan blade which is with high speed running

- a. Forbid using the machine in the environment with inflammable or flammable gas, avoid long time shine by the sunshine.
- b. Avoid putting the machine on oblique or unbalanced place. Avoid the machine fall down.
- c. Please do not let the air intake or air outlet close to the wall, curtain etc. material object. Otherwise, will block up the air current.
- d. If the water tank has water, please do not slope or knock the machine when you lay up or move the machine. Please move the machine from the side carefully, to avoid the water overflow.
- e. Please do not put some flaming appliance below the wind can blow over. Otherwise produce carbon monoxide.
- f. Long time not use the machine, please empty the water tank. Then let the machine works 10 minutes in the blast model. Cut the power supply after the wetted curtain is dry.
- g. If use the socket to supply power, the socket should be accord with Standard IEC60884-1/ABNT NBR NM 60884-1. When use the power wire to supply power, should to install a switch with open spread more than 3mm.

- 1)The appliance is not to be used by persons (including children) with reduced physical, sensory or mental capabilities, or lack of experience and knowledge, unless they have been given supervision or instruction.
- 2)Children being supervised not to play with the appliance.
- 3)If the supply cord is damaged, It must be replaced by the manufacture, its service agent or similarly qualified persons in order to avoid a hazard.
- 4)Always place the appliance with the stand, if any, on a heat-resistant, stable flat surface;
- 5)If the supply cord is damaged, It must be replaced by the manufacture, its service agent or similarly qualified persons in order to avoid a hazard;

Ensure that the fan is switched off from the supply mains before removing the guard.

Evaporative Air Cooler

6,Parts identification

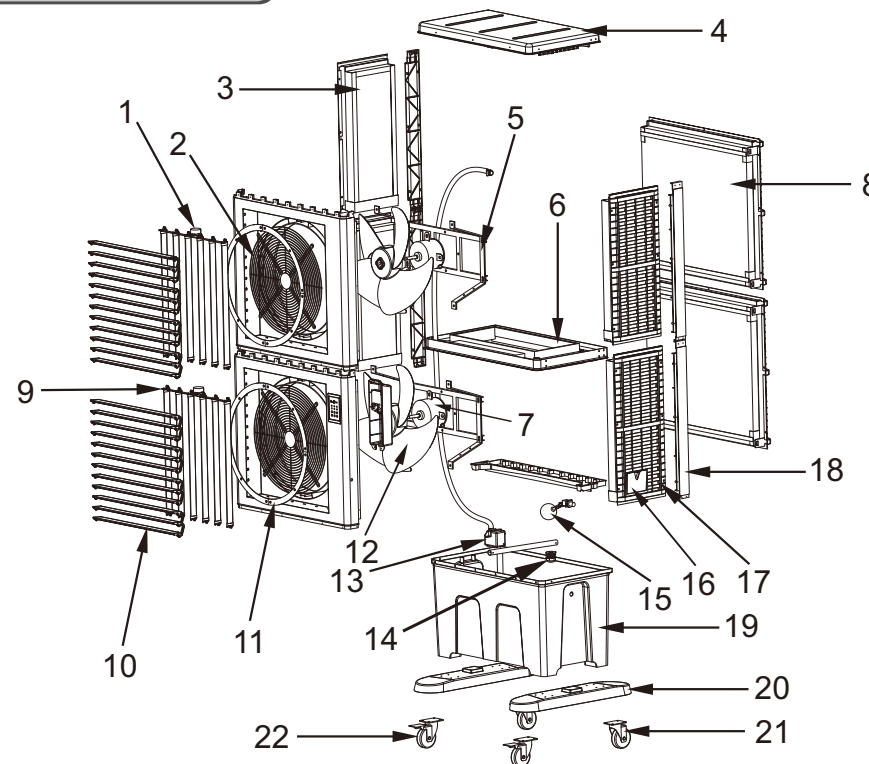

S.N	Spare parts	S.N	Spare parts
1	Swing wind motor	12	Fan blade
2	Wind nets	13	Circle pump
3	Left cooling pad	14	Drainage spiral
4	Head cover	15	Float ball
5	Motor bracket	16	Water inlet cover
6	Double layer connection	17	Right shutter
7	Motor	18	Back side panel (right)
8	Back cooling pads	19	Water tank
9	Left and right swing wind rod	20	Support frame
10	Swing up and down wind pieces	21	Activity castor
11	Arc plate	22	Brake castor

Evaporative Air Cooler

7,Parameter

Product model	ZC-76Y3-2
Voltage/Hz	220~240V/60Hz
Power consumption	3.3A
Water consumption	15~18L/h
Air outlet size(mm)	605X635
Noise	69dB
Maximum airflow	9.5m/s
Power	730W
Water capacity	120L
Dimension(mm)	860X720X2208mm
Net weight	71kg
Blower style	axis-flow model

8,Circuit principle diagram

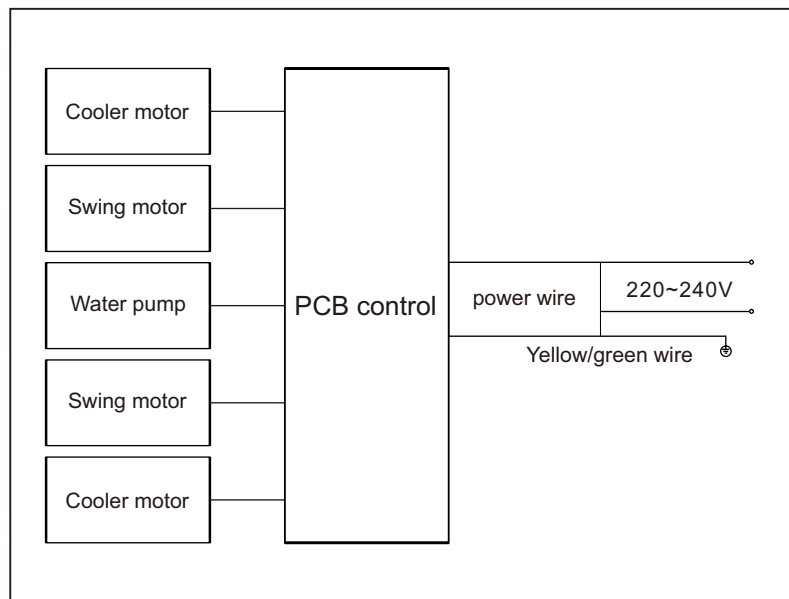

Evaporative Air Cooler

9,Dos and don'ts

In order to avoid damage, please follow the below items:

No specialized staff or no authorized repairman, can not repair or remake the machine



Maybe cause fire, or be injured by abnormal action

Please don't use when the voltage is lower than 220~240V

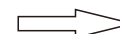

Easy to cause fire or electrocution

Please use the socket with rated current bigger than 5A

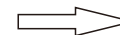

Easy to cause fire

This machine should to use single phase bipolar power supply. And the plug should with earth wire which should be sure to connect the earth.



When the machine have malfunction or electric leakage, the people is easy to get an electric shock

When you pull out the plug, please make sure to catch the head of the plug, but not the power wire. Forbid to pull out the plug by wet hand



Easy to cause an electric shock or short circuit

Please do not crumble, bend, hard draw, twist or bind the power wire. Please do not put heavy object on the power wire. When the power wire ages, tie off, damage, should to stop use the power wire

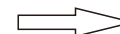

Easy to cause fire or get an electric shock